

# Heron Room

MSC 3709 | Third Floor

[See Building Floor Plan >](#)

1,325 sq. ft.



## Room Features

- Carpeted
- Built-In Counter Space
- Please note that this room contains a structural pillar, indicated on the floor plan below

## Audio/Visual Features

- Projector & Screen
- Speakers
- HDMI Cable
- Airmedia – Wireless Connection to Projector
- In-Room Computer (Additional Charge)

### Floor Plan

Heron Room – MSC 3709

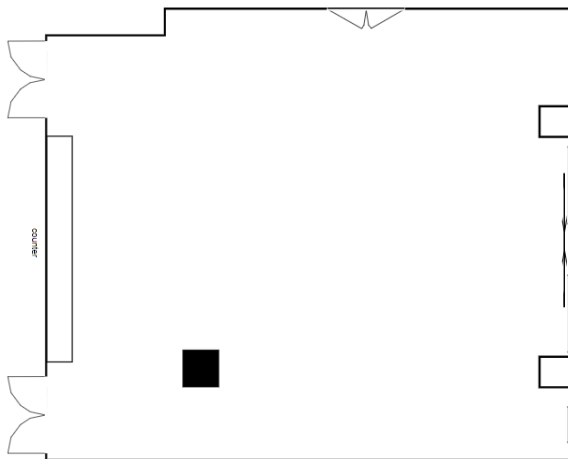

### Classroom

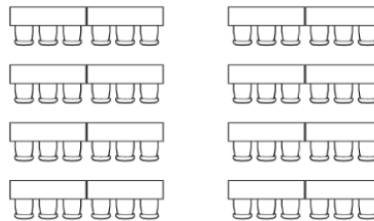

### U-Shape

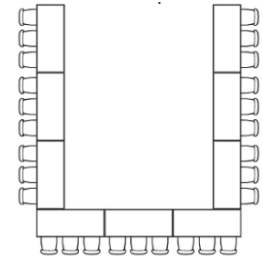

### Hollow Square

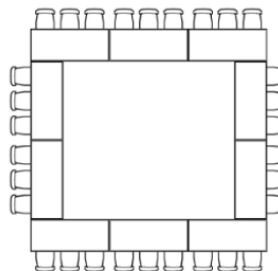

### Theater

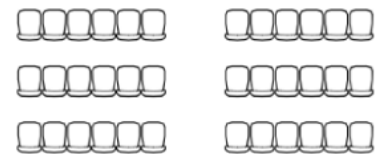

### Banquet

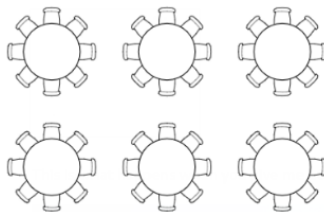

### Capacities by Setup Type

Banquet Rounds: Up to 64 people  
Theater: Up to 87 people  
Hollow Square: Up to 35 people  
U-Shape: Up to 27 people  
Classroom: Up to 54 people

Maximum capacities reflected above may not be possible depending on your event needs. Talk with a representative for the most accurate information.



**MARSHALL STUDENT CENTER EVENT & MEETING SERVICES**

813-974-5213 • MSC 4100

sa-ems@usf.edu • usf.edu/msc



**UNIVERSITY of  
SOUTH FLORIDA**  
Student Success