

SINGLE SOURCE CERTIFICATION

Authority is requested to make the following purchase under the provision of USF System Regulation USF4.02010(IV)(A)(2)(b) as a non-competitive purchase available from only one source. By submitting this form, department acknowledges that existing [exemptions](#) will not apply to this purchase. Single source requests exceeding \$75,000 must be signed by a Procurement Director and posted publicly for (3) business days.

DATE: _____

ITEM(S): _____

PRICE: \$ _____ FUND #: _____

SUPPLIER ID: _____ REQUISITION#: _____

SUPPLIER NAME: _____

FEDERAL GRANT: ___Y___N

In your words, describe the equipment, commodity, or contractual service. Explain how these specifications are essential to the accomplishment of your work:

In your own words, describe the reason(s) the item is not subject to competition from other sources and how the stated specification(s) restrict the requisition to only one supplier. Description may include unique features/compatibility/specifications/availability/delivery time frame etc. (Note: Price is not a valid reason).

In your own words, describe the due diligence conducted to validate this supplier as Single Source. Description SHOULD list all other suppliers with item(s)/service(s) with similar functions, your efforts to identify other suppliers, and why these suppliers would not qualify to submit a competitive quote.

Brisanne Matier _____ 3/2/2023 _____

Approved By (Procurement) DATE

Authority: USF4.02010(IV)(A)(2)(b)

START _____ END _____

PUBLIC POSTING DATES

Last Modified: 05/10/2021



About 8K Solutions

The 8K Solutions team has over 100 years combined experience in the sports technology field and is solely dedicated to the purposeful innovation of solutions for the athletics market. 8K Solutions has created solutions that are industry standard for safely and efficiently capturing practices and games, with our MastRcam and SmartField Family of Products and have revolutionized how players are trained with our Lyvve Coach, Walk Through Wall and 3D Playbook family of products.

We could not be prouder of our clients and strive every day to exceed their expectations. We appreciate your consideration of our solutions and services.

Budget Proposal

This budget proposal is for a variety of possible camera configurations and control systems. This budget proposal should serve as cost guidance for a system to ultimately be engineered to include owners responsibilities, and final product selection and price.

Submitted By:
BrandonDoughty
Account Manager
bdoughty@8ksolutions.com
(954) 812-7420



Prepared for:
USF Football
Phillip Cane





8850 Grissom Pkwy.
Titusville, FL 32780
8ksolutions.com

Project Summary

8K Solutions will engineer, project manage, install, commission train and support the following camera solutions for the University of South Florida Football Team:

Camera Locations

(5) Indoor Beam Mounted Panasonic UE 100 PTZ Cameras

- (2) South End Zone Location
- (2) West Sideline Location
- (1) North End Zone Location

Control System

Smart Field Control System:

- (5) Control Stations linear (1) control station designated to each camera.

Similar Projects completed by 8K Solutions.

Army West Point, Arizona Cardinals Ball State Football, Boston College, Buffalo Bills, Central Michigan Football, Clemson Football, Cleveland Browns, Detroit Lions, Houston Texans, Indianapolis Colts, Jacksonville Jaguars, Kansas Football, Miami Dolphins, Michigan Football, Michigan State, Minnesota Vikings, New York Jets, Northwestern Football, North Texas Football, Notre Dame, Oakland Raiders, SMU Football, Tennessee Titans, University of Texas Football, US Air Force Academy, Vanderbilt Football, Virginia Football

Key Products Used in this Project

Panasonic UE100 PTZ Camera

A wide angle lens with a horizontal angle of view of 74.1 degrees enables a wide area to be shot from a limited installation space, and 24x optical zoom maintains high image quality at high zoom ratios. This allows shooting in large indoor spaces.



SmartField Video Control Room Camera Control System:

- Camera Controller Panasonic RP60
- Panasonic UMR 20
- 8K Red Button Trigger Interface
- 8K Camera Select Station
 - (enables user to select any camera on the system)
- 21" Broadcast Monitor on Articulating Arm
- Multiview Display (shows feed for all cameras on the network)
- 8K Camera on/off flip switch system



8K Solutions Gold Maintenance and Support

the best ability is availability and 8K Support team is always available.

8K Solutions prides itself in protecting your investment and understanding the critical and time sensitive nature of our solutions availability. Our Gold Maintenance and Support includes the following features:

- 24 x 7 x 365 Phone and Email Support
- Next Day advanced Replacement Parts
- Annual On-Site Preventative Maintenance Visit
- Escalated On-Site Support
- Tutorial Videos (8K Website)
- Knowledge Base (8K Website)

Budget Summary *(tentative to final engineering)*

QTY	Product	Unit Price	Gold M&S (1st Year)	Subtotal
Indoor Cameras				fund 4 FFE over
5	Panasonic AW UE100 PANASONIC AWUE 100 4K NDI PTZ CAMERA	\$7,295.00	\$1,823.75	\$38,298.75
5	Custom Camera Mounting Package	\$745.00	\$186.25	\$3,911.25
5	Modern Tech Camera Color Balance	\$550.00	\$0.00	\$2,750.00
Control Room				fund 4 FFE over
5	Panasonic Control Station RP 60Camera Controller, 21" Monitor with Articulating Arm, URM20 with Mounts & Red Button,	\$6,852.20	\$1,713.05	\$35,974.05
Transmission, Receive, Rack Components				
1	Fiber Transmission Box (Dual Camera) (2) Camera transmission components in same box	\$3,204.58	\$160.23	\$3,364.81
2	Fiber Transmission Box (Single Camera) copy HAMMOND 1418D8 Box, AJA FIDO-T, SWITCH, SWITCH	\$2,488.06	\$0.00	\$4,976.12
4	Fiber Receiver Components (per camera) Fido R, Media Converter, Web Relay	\$892.35	\$178.47	\$3,747.87
1	Rack Mount Remote Camera Power	\$995.00	\$49.75	\$1,044.75
1	Video Room Cable Package	\$755.00	\$37.75	\$792.75
Engineering, Project Management, Installation Labor, Commissioning & Training				

fund 4 construction \$41,562.25

17	On Site Installation Labor, Staging Commissioning, Engineering, Project Management <small>Per Day includes Travel and Per Diem</small>	\$1,875.00	\$1,593.75	\$33,468.75
5	Engineering, Assembly, Testing, Commissioning	\$875.00	\$218.75	\$4,593.75
1	Lift Rental	\$3,500.00	\$0.00	\$3,500.00

Subtotal **\$136,422.85**

Total \$136,422.85

Owners Responsibilities

At NORTH EZ Camera location:

1. Install 8K supplied [Hammond 1418D8](#) wall mount weatherproof enclosure
 1. Hammond enclosures are to be located **directly below the camera at serviceable height and location** coordinated with 8K (see 8K marked up drawings)
 2. Provide 1" conduit pathway from Hammond enclosure to junction box at camera elevation (see 8K marked up drawings)
 3. Connect pre-installed quad receptacle inside the Hammond enclosure to a dedicated 20A circuit.
 4. Connect the pre-installed fiber connector housing [Corning SPH-01P](#) and patch panel [CCH-CP12-A9](#) to OFOI *****6 strand***** fiber connection leading to camera control room side Hammond enclosure.
 5. Install conduit and electrical to Hammond enclosure per 8K supplied document:
"Hammond_1418D_8K_CONFIG DETAIL R0 012720"

At SOUTH EZ Camera location:

1. Provide 1.5" conduit pathway from camera elevation (see 8K marked up drawings) to AV 110 (AV closet)
2. No Hammond enclosure needed, no fiber connectivity (all copper cabling at this location)

At WEST 50YL location:

1. Install 8K supplied [Hammond 1418D8](#) wall mount weatherproof enclosure

*****THIS HAMMOND ENCLOSURE WILL NOW SUPPORT 3 CAMERAS*****

- a. Hammond enclosures are to be located at 50 yard line at serviceable height and location coordinated with 8K (see 8K marked up drawings)
- b. Provide 1" conduit pathway from Hammond enclosure to junction box at SOUTH 40YL INDOOR camera elevation (see 8K marked up drawings)
- c. Provide 1" conduit pathway from Hammond enclosure to junction box at NORTH 40YL INDOOR camera elevation (see 8K marked up drawings)
- d. Provide 1" conduit pathway from Hammond enclosure to junction box at OUTDOOR camera elevation (see 8K marked up drawings)
- e. Connect pre-installed quad receptacle inside the Hammond enclosure to a dedicated 20A circuit.
- f. Connect the pre-installed fiber connector housing Corning SPH-01P and patch panel CCH-CP12-A9 to OFOI *****12 strand***** fiber connection leading to camera control room side Hammond enclosure.

- g. Install conduit and electrical to Hammond enclosure per 8K supplied document:
"Hammond_1418D_8K_CONFIG DETAIL R0 012720"

AV110:

1. Owner furnished equipment rack with min 8ru available space
2. Dedicated 20A circuit
3. Fiber patch panel with fiber connections to the following locations *****Single mode fiber w/ LC termination*****

Video Production 118:

1. Qty6 total camera control stations
 - a. Free desk/counter space, min 36"W x 24"D work surface per camera control station
 - b. Low voltage wall box with conduit path back to AV110 populated with the following cabling per camera control station
 - Qty1 RG6 coax cable, Belden1694 w/BNC termination (no substitution)
 - Qty2 cat5e, Belden or generic equivalent
 - c. Provide power for each desk/control station.

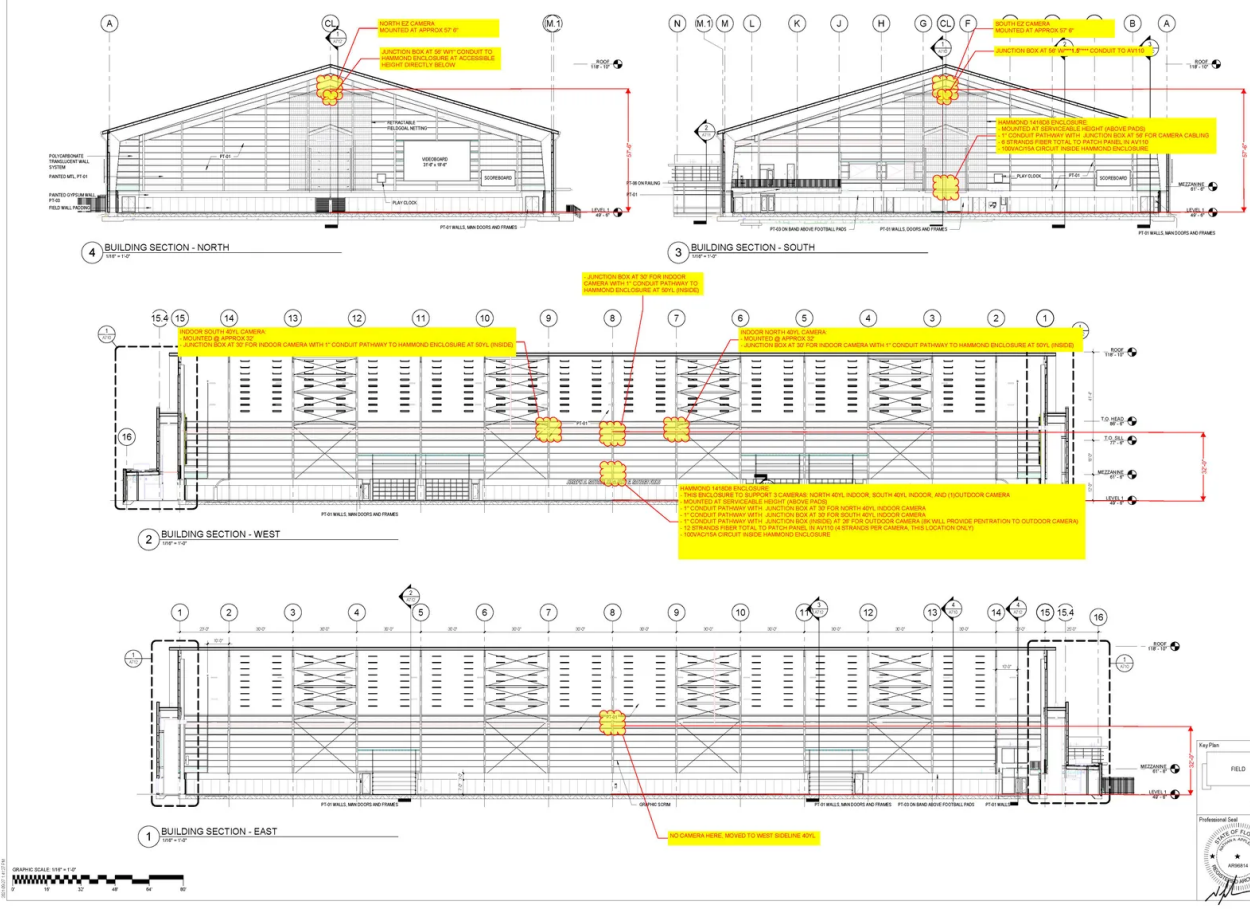

4 BUILDING SECTION - NORTH
1/8" = 1'-0"

3 BUILDING SECTION - SOUTH
1/8" = 1'-0"

2 BUILDING SECTION - WEST
1/8" = 1'-0"

1 BUILDING SECTION - EAST
1/8" = 1'-0"

GRADED SCALE: 1/8" = 1'-0"
1/8" = 1'-0"

OSK
HEATH, CORN & KOSBURN, INC.
300 West 23rd Street
Kissimmee, FL 34746 USA
+1 818 472 3380 | +1 818 472 2100
Sales Fax: 888.676.4342
FL Engineer No. 988324
Professional Seal
Certificate No. 27761-01

Consultants
Kensley Apps
Randy Smith
Karl G. Healy
Hardness Engineers, Inc.
4440 S. Dale Mabry Hwy., Suite 1100
Tampa, FL 33609
813.988.0000
www.hardnesseng.com

V&M Consulting Engineers
5000 N. Dale Mabry Ave., Suite 1000
Tampa, FL 33609
813.988.0000
www.vandm-engineers.com

State of Florida
Professional Seal
Certificate No. 14000-01

UNIVERSITY OF SOUTH FLORIDA
Facilities Management
4202 E Fowler Avenue | LPHM-100 | Tampa, FL 33620
Tampa Campus | M Services Center - Phone No. 813.974.2845

University of South Florida
Indoor Performance Facility
7200 USF Boulevard
Tampa, FL 33620
OVERALL BLDG SECTIONS

Revisions		Date	By	Checked

Key Plan
FIELD

Scale: As Shown
Graphic Scale: As Shown
UPN Project Number: USF 581
Issued For: Issued For Construction
Date Issued: 24 September 2021
Sheet Number: A701

Terms: Customer agrees to the total amount stated above. Deposit of 50% of total due net 10 days of signed agreement, Remaining balance due upon completion and customer signed acceptance.

Customer: University of South Florida

Signature:

Name & Title: Barry Clements

Date: 2023-02-03

Respectfully Submitted,

Brandon Doughty

Account Manager

Mobile: (954)812-7420

bdoughty@8ksolutions.com

8KSolutions.com