

HOUSING PREFERENCES FORM - COVID 19 Update Form

Response required for Housing at USF during 2021/22 academic year

Due to COVID-19 and the ongoing concern for the wellbeing of all students, the University of South Florida has released an [addendum](#) to the Housing Contracts. By choosing to live on campus, you are agreeing to the terms and conditions of the [addendum](#).

For floor plans and detailed information, see the next page and visit our accommodations site: www.intostudy.com/usf/housing

- **Only complete this form if you wish to have housing. Completion of this form is a signed agreement that you wish to have housing and are required to pay the \$2000.00 deposit.**

Please rank your housing preference below (with 1 being your first choice) and we will do our best to place you according to your preferences, but this will depend on availability. The University reserves the right to provide an alternative room type, which will be charged at the published rate. INTO USF is also adjusting priority placement to allow Undergraduate students to be housed in the spaces available, according to their preference order.

Ranking	Housing Type	Cost Per Semester* (Fall/Spring)
	Traditional Double style + All Access Meal Plan (Default housing)	\$7,000
	Traditional Single style + All Access Meal Plan	\$7,800
	Apartment style + All Access Meal Plan	\$8,800
	The Village Suite style + All Access Meal Plan	\$8,800
	The Village Traditional style + All Access Meal Plan	\$7,700

**The Open Access meal plan includes unlimited access to USF's three dining halls, seven days per week, and \$200 in Dining Dollars for use at on-campus restaurants and cafes. Housing and Dining rates are subject to change. The prices above reflect the current cost per semester for the current academic year. COVID-19 restrictions or adjustments might be in effect.*

Please indicate the number of semesters you would like housing:

1 2 3

I understand and confirm I am requesting on-campus housing from INTO USF.

Name: _____ Application/Unumber: _____ Date: _____



Apartment Style



8' x 10'

90 Sq Ft

Traditional Double Style



15' x 12'

170 Sq Ft

Traditional Single Style

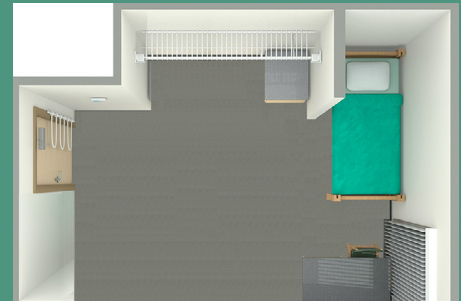

Village Suite Style



11'6" x 16'4"

213 Sq Ft

Village Traditional Style

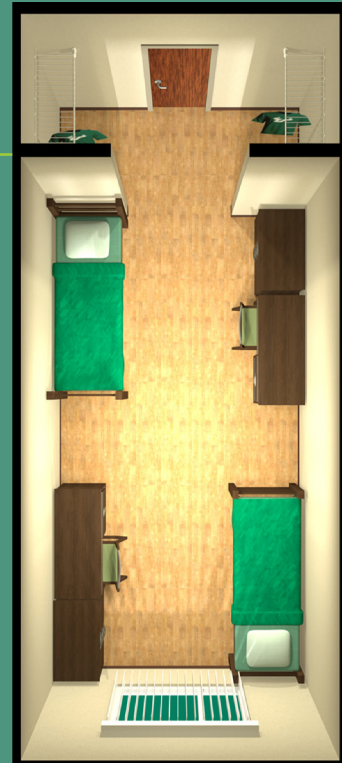

11'6" x 16'2"

185 Sq Ft

*The following are for reference purposes only. Layouts may vary depending on building